

CONTATTI LAMELLATI (FASTON)

Maschio 6.3 dritto in ferro stagnato

Codice Adimpex: **VA062343-R**

FASTON MS 6.3#p1,3

Serie:FTE844

p/n:FTE844 foro 1,3

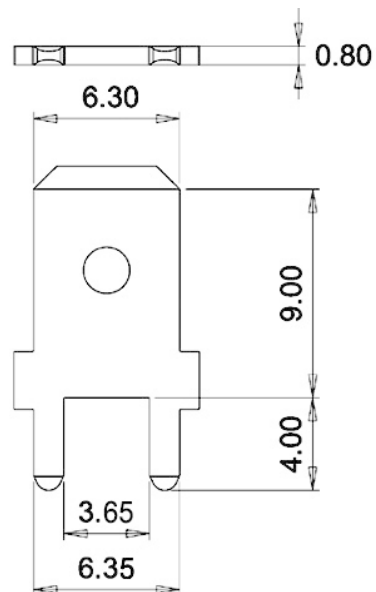
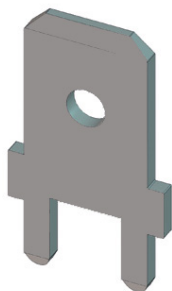

Codice Adimpex

VA062343

foro montaggio

ø 1.4