

Led

LED T-1 3/4 Ø5MM BIANCO (6649K) TYP. 10750MCD 30°

HL-508H256WC-4B-2.8-MD 5mm 10.75C 30° C BIA(6649K)

Codice Adimpex: **OFA05062JI**

P/N: **HL-508H256WC4B-2.8MD**

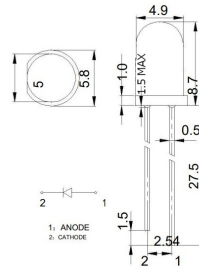

Tolerance		Dimension Tolerance (UNIT:mm)			
Grade	公差等级	0.5-3	3-6	6-30	30-120
		±0.1	±0.2	±0.3	±0.5
Material 材料		Chip 晶片		Lens Color 透镜颜色	
InGaN		Emitting Color 发光颜色 White		Water Clear 无色透明	

Caratteristiche Tecniche:

Intensità luminosa tipica (mcd):	>5001
Corrente Led (mA):	10-20
Angolo visivo:	30°
Colore:	Bianco neutral
Gamma:	Led
Dome Lens:	No
Alimentazione reverse:	No
Diametro PTH:	Ø5mm
Montaggio:	PTH
Tipo lente:	Water clear