

CONNETTORI TORNITI FEMMINA PASSO 2.54MM

Femmina singola fila H10.00mm mating pin ϕ 0.76mm/0.64 SQ

Codice Adimpex: **NPD05707-R**

C.FM g/s 2.54/07 SHA-0071-D131000A

Serie:SHA-1000A

p/n:SHA-0071-D131000A

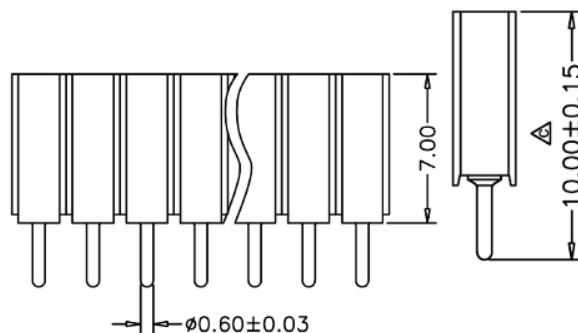
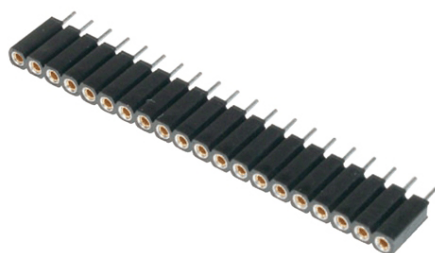
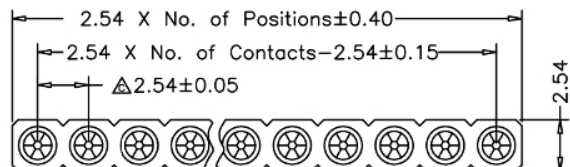

| Codice Adimpex | n. posizioni |
|-----------------|--------------|
| NPD05704 | 4 |
| NPD05705 | 5 |
| NPD05706 | 6 |
| NPD05707 | 7 |
| NPD05708 | 8 |
| NPD05709 | 9 |
| NPD05710 | 10 |

| Codice Adimpex | n. posizioni |
|----------------|--------------|
| NPD05711 | 11 |
| NPD05712 | 12 |
| NPD05713 | 13 |
| NPD05714 | 14 |
| NPD05715 | 15 |
| NPD05716 | 16 |
| NPD057xx | xx (01 ÷ 40) |

CARATTERISTICHE

- Corrente: 3 A
- Resistenza di isolamento: 1000 M Ω min.
- Resistenza di contatto: 4m Ω max.
- Rigidità dielettrica: 1000 V AC min.
- Temperatura di lavoro: -55°C ÷ +105°C
- Corpo: P.B.T. UL94V-0
- Contatto: rame berillio
- Terminale: ottone, tornito
- Finitura pin: selective gold
- Finitura clip: flash oro

FEATURES

- Current rate: 3 A
- Insulation resistance: 1000 M Ω min.
- Contact resistance: 4m Ω max.
- Dielectric voltage: 1000 V AC min.
- Operation temperature: -55°C ÷ +105°C
- Body: P.B.T. UL94V-0
- Contact clip: beryllium copper
- Sleeve: brass, machined
- Pin plating: selective gold
- Clip plating: gold flash