

## Connettori e terminali

### CONNETTORE MASCHIO 3962 90° 3P

CONN. MSRA p3.96 EX3962WR-03P

Codice Adimpex: **J3962703-R**

P/N: **396203WR001**

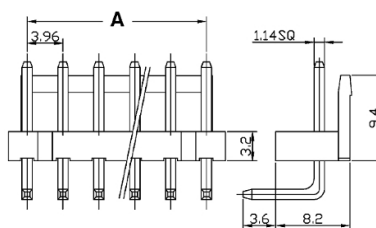
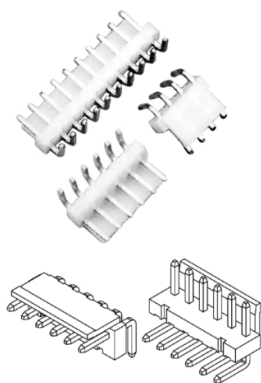

Dimensioni  
 $A = 3.96 \times (n - 1)$   
 $B = A + 3.96$   
 $n = n^{\circ}$  contatti

## Caratteristiche Tecniche:

Pin totali:	3
Passo:	3.96 mm
Serie:	3962
Orientamento:	90 gradi
Montaggio:	PTH
Tipologia:	Scheda-filo