

**SPINE MINI DIN**

**Spina Mini Din**

Codice Adimpex: **GQ001608-R**

SPINA DIN MIN 8P MDP-028 \*\*

Serie:A-9001

p/n:MDP-028-@

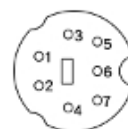
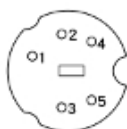
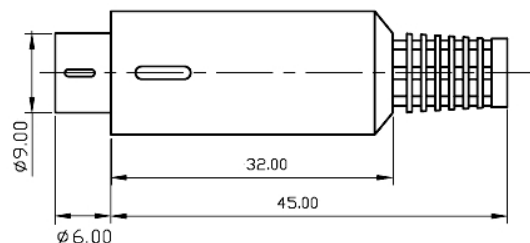

Codice Adimpex	Codice Adimpex	Codice Adimpex	Codice Adimpex	Codice Adimpex	Codice Adimpex
GQ001603	GQ001604	GQ001605	GQ001606	GQ001607	<b>GQ001608</b>

*CARATTERISTICHE*

- Portata: 1A 100V AC, 2A 12V DC
- Resistenza contatto: 30mΩ max.
- Resistenza d'isolamento: > 50MΩ a 250V DC
- Rigidità dielettrica: 250V AC per 1 minuto

*FEATURES*

- Rating: 1A 100V AC, 2A 12V DC
- Contact resistance: 30mΩ max.
- Insulation resistance: > 50MΩ at 250V DC
- Dielectric strength: 250V AC for 1 minute