

## Induttori e toroidi

### RADIALE SERIE CW78 220UH 660MA

IND R. CW78-221KNP 220uH 660mA\*\*

Codice Adimpex: **FH078122-R**

P/N: **CW78NP-221K**



#### \* SPECIFICATION \*

TYPE CW78NP

LDIMENSION (UNIT : mm)

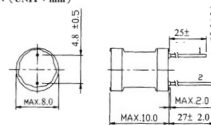

STAMPINGE g)



UNFIXED POSITION

\* THE LENGTH OF THE TERMINAL PINS DOES NOT INCLUDE SOLDER TIP.  
\* PIN PITCH TO BE MEASURED FROM THE ROOT OF TERMINAL.

## Caratteristiche Tecniche:

L (uH):	220
Pitch (mm):	4.8 e 5.0
Tipologia:	Induttori di blocco radiali PTH
Dimensione (mm):	Ø8 H10.0