

## Induttori e toroidi

### RADIALE SERIE CW78 33UH 1800MA

IND RAD CW78-330KNP 33uH 1800mA

Codice Adimpex: **FH078033-R**

P/N: **CW78NP-330K**



#### \* SPECIFICATION \*

TYPE CW78NP

LDIMENSION (UNIT : mm)

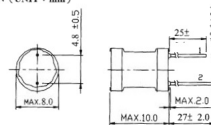

STAMPINGE(g)



UNFIXED POSITION

\* THE LENGTH OF THE TERMINAL PINS DOES NOT INCLUDE SOLDER TIP.  
\* PIN PITCH TO BE MEASURED FROM THE ROOT OF TERMINAL.

## Caratteristiche Tecniche:

L (uH):	33
Pitch (mm):	4.8 e 5.0
Tipologia:	Induttori di blocco radiali PTH
Dimensione (mm):	Ø8 H10.0