

Induttori e toroidi

RADIALE SERIE CW78 4.7UH 4600MA

IND RAD CW78-4R7MNP 4.7uH 4600mA

Codice Adimpex: **FH078.47-R**

P/N: **CW78NP-4R7M**



* SPECIFICATION *

TYPE CW78NP

LDIMENSION (UNIT : mm)

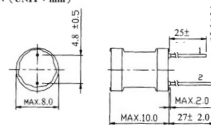

STAMPING (g)



UNFIXED POSITION

* THE LENGTH OF THE TERMINAL PINS DOES NOT INCLUDE SOLDER TIP.
* PIN PITCH TO BE MEASURED FROM THE ROOT OF TERMINAL.

Caratteristiche Tecniche:

L (uH):	4.7
Pitch (mm):	4.8 e 5.0
Tipologia:	Induttori di blocco radiali PTH
Dimensione (mm):	Ø8 H10.0