

## Induttori e toroidi

### RADIALE SERIE CW78 3.3UH 5800MA

IND RAD CW78-3R3MNP 3.3uH 5800mA

Codice Adimpex: **FH078.33-R**

P/N: **CW78NP-3R3M**



#### \* SPECIFICATION \*

TYPE CW78NP

LDIMENSION (UNIT : mm)

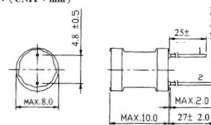

STAMPING (g)



UNFIXED POSITION

\* THE LENGTH OF THE TERMINAL PINS DOES NOT INCLUDE SOLDER TIP.  
\* PIN PITCH TO BE MEASURED FROM THE ROOT OF TERMINAL.

## Caratteristiche Tecniche:

L (uH):	3.3
Pitch (mm):	4.8 e 5.0
Tipologia:	Induttori di blocco radiali PTH
Dimensione (mm):	Ø8 H10.0