

CONDENSATORI ELETTROLITICI IN ALLUMINIO PER SMD

Serie VE (85°C)

Codice Adimpex: **C0421025-R**

CN.EL.M 1000uF 25V VE SMD 12.5x13.5

p/n:VE-102M1E1313-TRO

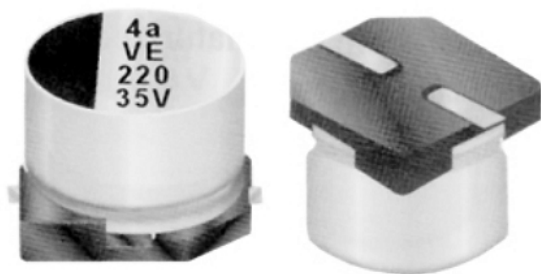

Fig. 1

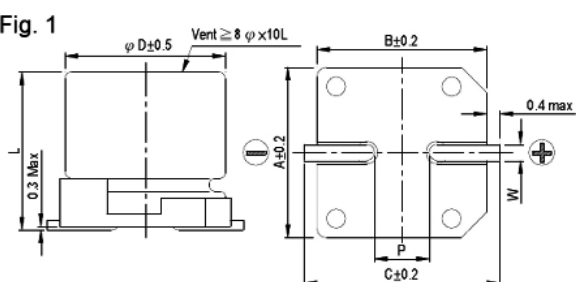
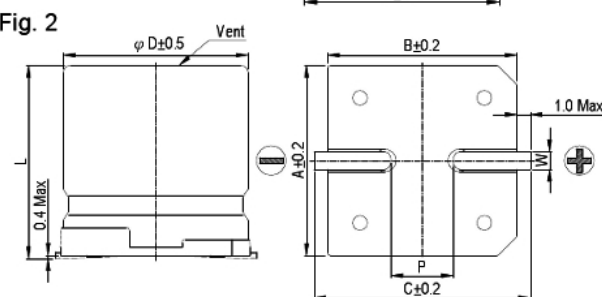

Fig. 2



Dimensioni (mm)					
Ø D	L	A	B	C	
3	5.3 ± 0.2	3.3	3.3	4.1	
4	5.3 ± 0.2	4.3	4.3	5.1	
5	5.3 ± 0.2	5.3	5.3	5.9	
6.3	5.3 ± 0.2	6.6	6.6	7.2	
6.3	7.7 ± 0.3	6.6	6.6	7.2	
8	10 ± 0.5	8.4	8.4	9.0	
8	10.3 ± 0.5	8.4	8.4	9.0	
10	7.7 ± 0.3	10.4	10.4	11.0	
10	10 ± 0.5	10.4	10.4	11.0	
10	10.3 ± 0.5	10.4	10.4	11.0	
12.5	13.5 ± 0.5	13.0	13.0	13.7	
12.5	16 ± 0.5	13.0	13.0	13.7	
16	16.5 ± 0.5	17.0	17.0	18.0	
16	21.5 ± 0.5	17.0	17.0	18.0	
18	16.5 ± 0.5	19.0	19.0	20.0	
18	21.5 ± 0.5	19.0	19.0	20.0	

Tensione (V)	10	16	25	35	50	63	100
Capacità (uF) ± 20%	Codice Adimpex Ø D x L mA						
1.0						C04.1063 4 x 5.3 8	
2.2						C04.2263 4 x 5.3 12	
3.3				C04.3335 3 x 5.3 14	C04.3350 4 x 5.3 17	C04.3363 5 x 5.3 22	
4.7		C04.4716 3 x 5.3 14			C04.4750 4 x 5.3 20	C04.4763 5 x 5.3 25	

10	C0401016 4 x 5.3 26			C0401050 5 x 5.3 35	C0401063 6.3 x 5.3 40	C0401090 8 x 10 90
22	C0402216 4 x 5.3 30		C0402235 5 x 5.3 47	C0402250 6.3 x 5.3 50		C0402290 8 x 10 90
33	C0403310 4 x 5.3 31	C0403325 5 x 5.3 55	C0403335 6.3 x 5.3 67	C0403350 6.3 x 7.7 75	C0403363 8 x 10 139	C0403390 10 x 10 120
47	C0404716 5 x 5.3 55	C0404725 6.3 x 5.3 75		C0404750 6.3 x 7.7 75		C0404790 10 x 10 120
100	C0411016 6.3 x 5.3 89		C0411035 6.3 x 7.7 130	C0411050 8 x 10 190	C0411063 10 x 10 226	C0411090 12.5 x 13.5 440
220	C0412216 6.3 x 7.7 124		C0412235 8 x 10 270	C0412250 10 x 10 320	C0412263 12.5 x 13.5 500	C0412290 16 x 16.5 600
330	C0413316 8 x 10 290	C0413325 10 x 10 400	C0413335 10 x 10.3 400	C0413350 12.5 x 13.5 600	C0413363 12.5 x 16 600	C0413390 18 x 16.5 780
470	C0414710 10 x 7.7 290	C0414725 10 x 10 400	C0414735 12.5 x 13.5 750	C0414750 12.5 x 16 740	C0414763 16 x 16.5 850	
1000	C0421010 10 x 10 430	C0421025 12.5 x 13.5 750	C0421035 16 x 16.5 1100	C0421050 18 x 16.5 1350		
2200	C0422210 12.5 x 13.5 890	C0422225 16 x 16.5 1100	C0422235 18 x 16.5 1450			
3300	C0423316 16 x 16.5 1300	C0423325 18 x 16.5 1450	C0423335 18 x 21.5 1750			
4700	C0424710 16 x 16.5 1400	C0424716 18 x 16.5 1600	C0424725 18 x 21.5 1750			
6800	C0426810 18 x 16.5 1700	C0426816 18 x 21.5 2000				
10000	C0431010 18 x 21.5 2000					

Tensione (V)	160	200	250	400	450
Capacità (uF) ± 20%	Codice Adimpex ø D x L mA				
4.7					C64.4745 12.5 x 13.5 120
10				C6401040 12.5 x 13.5 120	C6401045 12.5 x 16 130
22			C6402225 12.5 x 13.5 150		C6402245 16 x 16.5 140
33	C6403316 12.5 x 13.5 290		C6403325 12.5 x 16 240	C6403340 16 x 16.5 140	C6403345 18 x 16.5 180
47	C6404716 12.5 x 16 370		C6404725 16 x 16.5 340	C6404740 18 x 16.5 280	C6404745 18 x 21.5 250
100		C6411020 18 x 16.5 550	C6411025 18 x 21.5 490		

CARATTERISTICHE

- Tipo standard
- Gamma di temperatura: -40°C ÷ +85°C
- Durata test: 2.000 ore

FEATURES

- Standard type
- Operating temperature range: -40°C ÷ +85°C
- Test time: 2.000 hours