

**CONDENSATORI ELETTROLITICI IN ALLUMINIO PER SMD**

**Serie VE (85°C)**

Codice Adimpex: **C0404725-R**

CON EL M 47uF 25V VE SMD 6.3x5.3

p/n:VE-470M1E0605-TR0

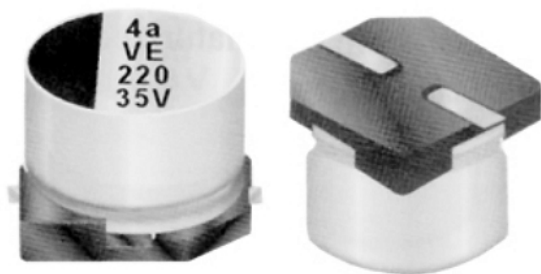

Fig. 1

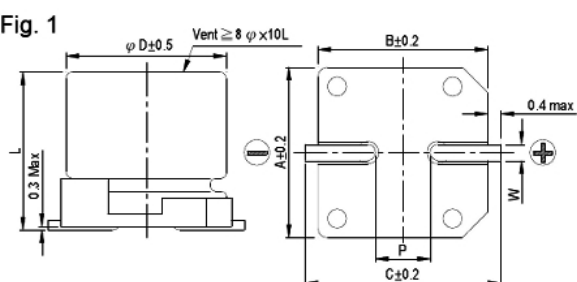
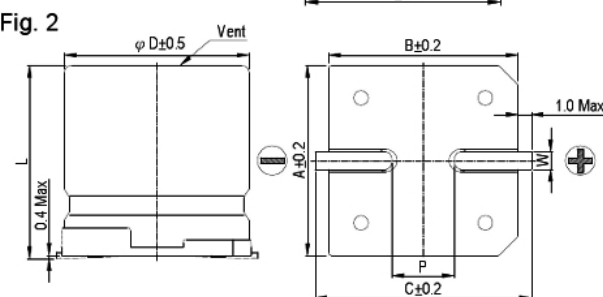

Fig. 2



| Dimensioni (mm) |            |      |      |      |
|-----------------|------------|------|------|------|
| Ø D             | L          | A    | B    | C    |
| 3               | 5.3 ± 0.2  | 3.3  | 3.3  | 4.1  |
| 4               | 5.3 ± 0.2  | 4.3  | 4.3  | 5.1  |
| 5               | 5.3 ± 0.2  | 5.3  | 5.3  | 5.9  |
| 6.3             | 5.3 ± 0.2  | 6.6  | 6.6  | 7.2  |
| 6.3             | 7.7 ± 0.3  | 6.6  | 6.6  | 7.2  |
| 8               | 10 ± 0.5   | 8.4  | 8.4  | 9.0  |
| 8               | 10.3 ± 0.5 | 8.4  | 8.4  | 9.0  |
| 10              | 7.7 ± 0.3  | 10.4 | 10.4 | 11.0 |
| 10              | 10 ± 0.5   | 10.4 | 10.4 | 11.0 |
| 10              | 10.3 ± 0.5 | 10.4 | 10.4 | 11.0 |
| 12.5            | 13.5 ± 0.5 | 13.0 | 13.0 | 13.7 |
| 12.5            | 16 ± 0.5   | 13.0 | 13.0 | 13.7 |
| 16              | 16.5 ± 0.5 | 17.0 | 17.0 | 18.0 |
| 16              | 21.5 ± 0.5 | 17.0 | 17.0 | 18.0 |
| 18              | 16.5 ± 0.5 | 19.0 | 19.0 | 20.0 |
| 18              | 21.5 ± 0.5 | 19.0 | 19.0 | 20.0 |

| Tensione (V)        | 10                             | 16 | 25                       | 35                       | 50                       | 63                       | 100 |
|---------------------|--------------------------------|----|--------------------------|--------------------------|--------------------------|--------------------------|-----|
| Capacità (uF) ± 20% | Codice Adimpex<br>Ø D x L   mA |    |                          |                          |                          |                          |     |
| 1.0                 |                                |    |                          |                          |                          | C04.1063<br>4 x 5.3   8  |     |
| 2.2                 |                                |    |                          |                          |                          | C04.2263<br>4 x 5.3   12 |     |
| 3.3                 |                                |    | C04.3335<br>3 x 5.3   14 | C04.3350<br>4 x 5.3   17 | C04.3363<br>5 x 5.3   22 |                          |     |
| 4.7                 | C04.4716<br>3 x 5.3   14       |    |                          | C04.4750<br>4 x 5.3   20 | C04.4763<br>5 x 5.3   25 |                          |     |

|       |                               |                               |                               |                               |                               |                               |
|-------|-------------------------------|-------------------------------|-------------------------------|-------------------------------|-------------------------------|-------------------------------|
| 10    | C0401016<br>4 x 5.3   26      |                               |                               | C0401050<br>5 x 5.3   35      | C0401063<br>6.3 x 5.3   40    | C0401090<br>8 x 10   90       |
| 22    | C0402216<br>4 x 5.3   30      |                               | C0402235<br>5 x 5.3   47      | C0402250<br>6.3 x 5.3   50    |                               | C0402290<br>8 x 10   90       |
| 33    | C0403310<br>4 x 5.3   31      | C0403325<br>5 x 5.3   55      | C0403335<br>6.3 x 5.3   67    | C0403350<br>6.3 x 7.7   75    | C0403363<br>8 x 10   139      | C0403390<br>10 x 10   120     |
| 47    | C0404716<br>5 x 5.3   55      | C0404725<br>6.3 x 5.3   75    |                               | C0404750<br>6.3 x 7.7   75    |                               | C0404790<br>10 x 10   120     |
| 100   | C0411016<br>6.3 x 5.3   89    |                               | C0411035<br>6.3 x 7.7   130   | C0411050<br>8 x 10   190      | C0411063<br>10 x 10   226     | C0411090<br>12.5 x 13.5   440 |
| 220   | C0412216<br>6.3 x 7.7   124   |                               | C0412235<br>8 x 10   270      | C0412250<br>10 x 10   320     | C0412263<br>12.5 x 13.5   500 | C0412290<br>16 x 16.5   600   |
| 330   | C0413316<br>8 x 10   290      | C0413325<br>10 x 10   400     | C0413335<br>10 x 10.3   400   | C0413350<br>12.5 x 13.5   600 | C0413363<br>12.5 x 16   600   | C0413390<br>18 x 16.5   780   |
| 470   | C0414710<br>10 x 7.7   290    | C0414725<br>10 x 10   400     | C0414735<br>12.5 x 13.5   750 | C0414750<br>12.5 x 16   740   | C0414763<br>16 x 16.5   850   |                               |
| 1000  | C0421010<br>10 x 10   430     | C0421025<br>12.5 x 13.5   750 | C0421035<br>16 x 16.5   1100  | C0421050<br>18 x 16.5   1350  |                               |                               |
| 2200  | C0422210<br>12.5 x 13.5   890 | C0422225<br>16 x 16.5   1100  | C0422235<br>18 x 16.5   1450  |                               |                               |                               |
| 3300  | C0423316<br>16 x 16.5   1300  | C0423325<br>18 x 16.5   1450  | C0423335<br>18 x 21.5   1750  |                               |                               |                               |
| 4700  | C0424710<br>16 x 16.5   1400  | C0424716<br>18 x 16.5   1600  | C0424725<br>18 x 21.5   1750  |                               |                               |                               |
| 6800  | C0426810<br>18 x 16.5   1700  | C0426816<br>18 x 21.5   2000  |                               |                               |                               |                               |
| 10000 | C0431010<br>18 x 21.5   2000  |                               |                               |                               |                               |                               |

| Tensione (V)        | 160                            | 200                         | 250                           | 400                           | 450                           |
|---------------------|--------------------------------|-----------------------------|-------------------------------|-------------------------------|-------------------------------|
| Capacità (uF) ± 20% | Codice Adimpex<br>ø D x L   mA |                             |                               |                               |                               |
| 4.7                 |                                |                             |                               |                               | C64.4745<br>12.5 x 13.5   120 |
| 10                  |                                |                             |                               | C6401040<br>12.5 x 13.5   120 | C6401045<br>12.5 x 16   130   |
| 22                  |                                |                             | C6402225<br>12.5 x 13.5   150 |                               | C6402245<br>16 x 16.5   140   |
| 33                  | C6403316<br>12.5 x 13.5   290  |                             | C6403325<br>12.5 x 16   240   | C6403340<br>16 x 16.5   140   | C6403345<br>18 x 16.5   180   |
| 47                  | C6404716<br>12.5 x 16   370    |                             | C6404725<br>16 x 16.5   340   | C6404740<br>18 x 16.5   280   | C6404745<br>18 x 21.5   250   |
| 100                 |                                | C6411020<br>18 x 16.5   550 | C6411025<br>18 x 21.5   490   |                               |                               |

## CARATTERISTICHE

- Tipo standard
- Gamma di temperatura: -40°C ÷ +85°C
- Durata test: 2.000 ore

## FEATURES

- *Standard type*
- *Operating temperature range: -40°C ÷ +85°C*
- *Test time: 2.000 hours*