

**CONDENSATORI ELETTROLITICI IN ALLUMINIO PER SMD**

**Serie VE (85°C)**

Codice Adimpex: **C0404716-R**

CON EL M 47uF 16V VE SMD 5x5.3

p/n:VE-470M1C0505-TR0

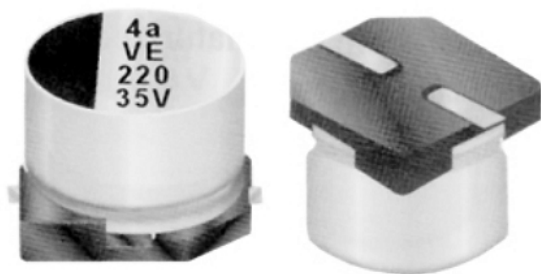

Fig. 1

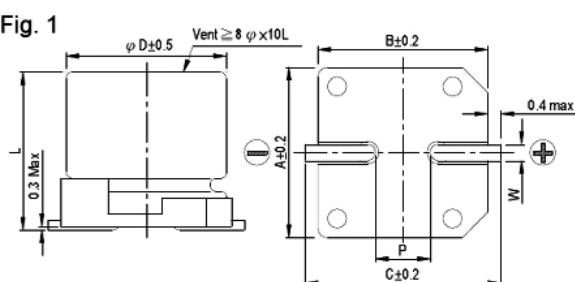
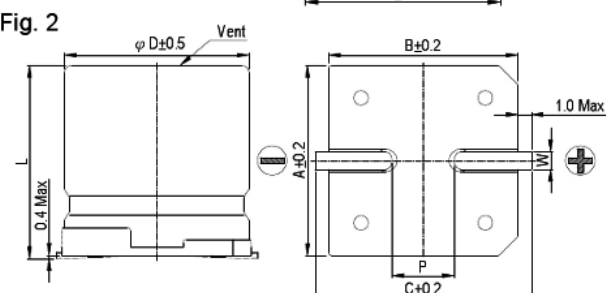

Fig. 2



Dimensioni (mm)				
Ø D	L	A	B	C
3	5.3 ± 0.2	3.3	3.3	4.1
4	5.3 ± 0.2	4.3	4.3	5.1
5	5.3 ± 0.2	5.3	5.3	5.9
6.3	5.3 ± 0.2	6.6	6.6	7.2
6.3	7.7 ± 0.3	6.6	6.6	7.2
8	10 ± 0.5	8.4	8.4	9.0
8	10.3 ± 0.5	8.4	8.4	9.0
10	7.7 ± 0.3	10.4	10.4	11.0
10	10 ± 0.5	10.4	10.4	11.0
10	10.3 ± 0.5	10.4	10.4	11.0
12.5	13.5 ± 0.5	13.0	13.0	13.7
12.5	16 ± 0.5	13.0	13.0	13.7
16	16.5 ± 0.5	17.0	17.0	18.0
16	21.5 ± 0.5	17.0	17.0	18.0
18	16.5 ± 0.5	19.0	19.0	20.0
18	21.5 ± 0.5	19.0	19.0	20.0

Tensione (V)	10	16	25	35	50	63	100
Capacità (uF) ± 20%	Codice Adimpex Ø D x L   mA						
1.0							<b>C04.1063</b> 4 x 5.3   8
2.2							<b>C04.2263</b> 4 x 5.3   12
3.3				<b>C04.3335</b> 3 x 5.3   14	<b>C04.3350</b> 4 x 5.3   17	<b>C04.3363</b> 5 x 5.3   22	
4.7		<b>C04.4716</b> 3 x 5.3   14			<b>C04.4750</b> 4 x 5.3   20	<b>C04.4763</b> 5 x 5.3   25	

10	C0401016 4 x 5.3   26			C0401050 5 x 5.3   35	C0401063 6.3 x 5.3   40	C0401090 8 x 10   90
22	C0402216 4 x 5.3   30		C0402235 5 x 5.3   47	C0402250 6.3 x 5.3   50		C0402290 8 x 10   90
33	C0403310 4 x 5.3   31	C0403325 5 x 5.3   55	C0403335 6.3 x 5.3   67	C0403350 6.3 x 7.7   75	C0403363 8 x 10   139	C0403390 10 x 10   120
47	C0404716 5 x 5.3   55	C0404725 6.3 x 5.3   75		C0404750 6.3 x 7.7   75		C0404790 10 x 10   120
100	C0411016 6.3 x 5.3   89		C0411035 6.3 x 7.7   130	C0411050 8 x 10   190	C0411063 10 x 10   226	C0411090 12.5 x 13.5   440
220	C0412216 6.3 x 7.7   124		C0412235 8 x 10   270	C0412250 10 x 10   320	C0412263 12.5 x 13.5   500	C0412290 16 x 16.5   600
330	C0413316 8 x 10   290	C0413325 10 x 10   400	C0413335 10 x 10.3   400	C0413350 12.5 x 13.5   600	C0413363 12.5 x 16   600	C0413390 18 x 16.5   780
470	C0414710 10 x 7.7   290	C0414725 10 x 10   400	C0414735 12.5 x 13.5   750	C0414750 12.5 x 16   740	C0414763 16 x 16.5   850	
1000	C0421010 10 x 10   430	C0421025 12.5 x 13.5   750	C0421035 16 x 16.5   1100	C0421050 18 x 16.5   1350		
2200	C0422210 12.5 x 13.5   890	C0422225 16 x 16.5   1100	C0422235 18 x 16.5   1450			
3300	C0423316 16 x 16.5   1300	C0423325 18 x 16.5   1450	C0423335 18 x 21.5   1750			
4700	C0424710 16 x 16.5   1400	C0424716 18 x 16.5   1600	C0424725 18 x 21.5   1750			
6800	C0426810 18 x 16.5   1700	C0426816 18 x 21.5   2000				
10000	C0431010 18 x 21.5   2000					

Tensione (V)	160	200	250	400	450
Capacità (uF) ± 20%	Codice Adimpex ø D x L   mA				
4.7					C64.4745 12.5 x 13.5   120
10				C6401040 12.5 x 13.5   120	C6401045 12.5 x 16   130
22			C6402225 12.5 x 13.5   150		C6402245 16 x 16.5   140
33	C6403316 12.5 x 13.5   290		C6403325 12.5 x 16   240	C6403340 16 x 16.5   140	C6403345 18 x 16.5   180
47	C6404716 12.5 x 16   370		C6404725 16 x 16.5   340	C6404740 18 x 16.5   280	C6404745 18 x 21.5   250
100		C6411020 18 x 16.5   550	C6411025 18 x 21.5   490		

## CARATTERISTICHE

- Tipo standard
- Gamma di temperatura: -40°C ÷ +85°C
- Durata test: 2.000 ore

## FEATURES

- *Standard type*
- *Operating temperature range: -40°C ÷ +85°C*
- *Test time: 2.000 hours*