

Resistori

PRM RADIALE $\pm 5\%$ 5.6K Ω

RESIST.C CER PRM 10W J 5K6 RD

Codice Adimpex: **AR400256-R**

P/N: **PRM0AWJP562B00**

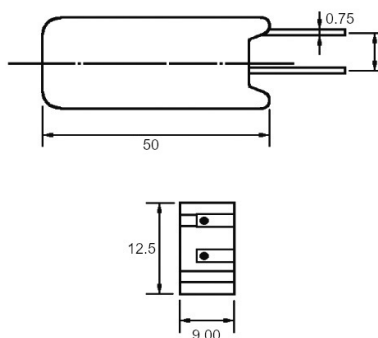

Caratteristiche Tecniche:

Potenza (W):	10 W
Dimensione cassa ceramica (mm):	12.5x9 L50
Resistenza (Ohm):	5.6K
Tipologia:	Radiale
Gamma:	Resistori in cassa ceramica