

Induttori e toroidi

RADIALE SERIE CW78 47000UH 35MA

IN RD CW78-473KNP 47000uH 35mA

Codice Adimpex: **FH078347-R**

P/N: **CW78NP-473K**



* SPECIFICATION *

TYPE CW78NP

LDIMENSION (UNIT : mm)

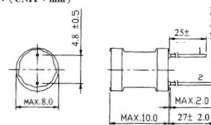

STAMPINGE(g)



UNFIXED POSITION

* THE LENGTH OF THE TERMINAL PINS DOES NOT INCLUDE SOLDER TIP.
* PIN PITCH TO BE MEASURED FROM THE ROOT OF TERMINAL.

Caratteristiche Tecniche:

Pitch (mm):	4.8 e 5.0
L (uH):	47000
Tipologia:	Induttori di blocco radiali PTH
Dimensione (mm):	Ø8 H10.0